

Package Contents

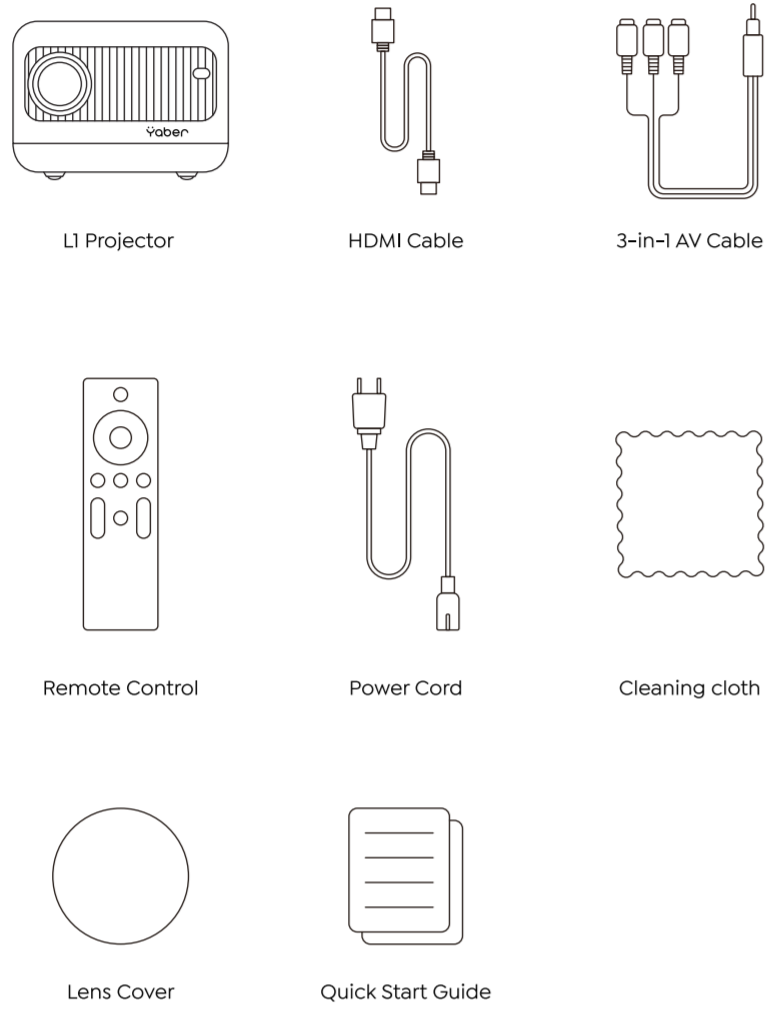

Product Overview

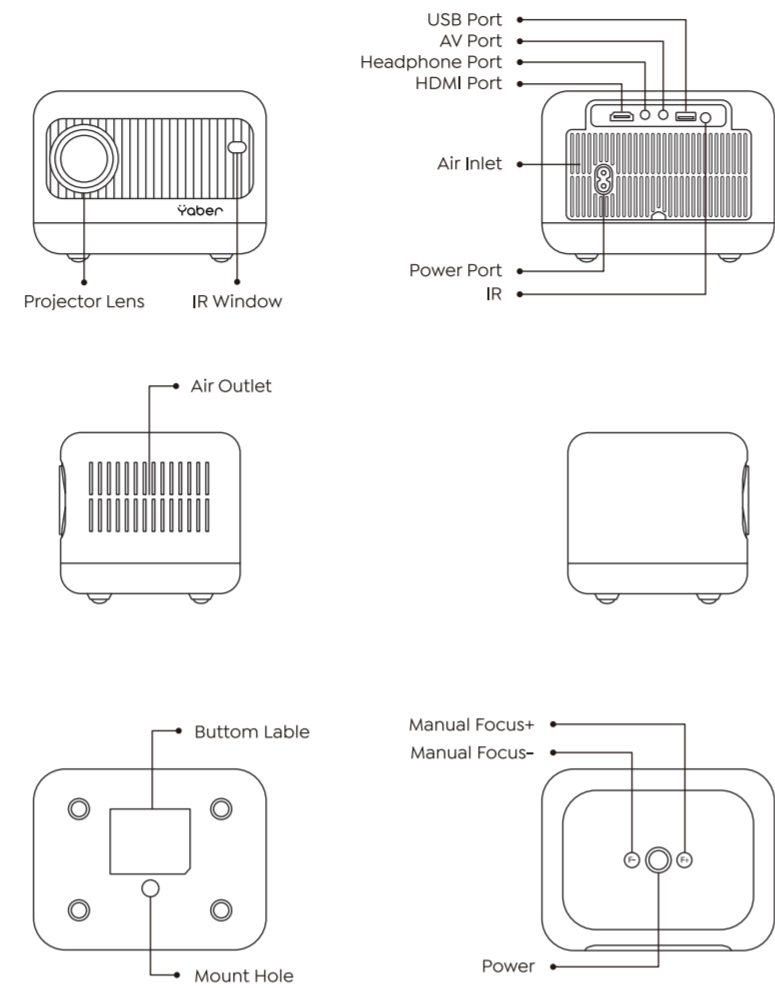

Turn on Yaber Projector

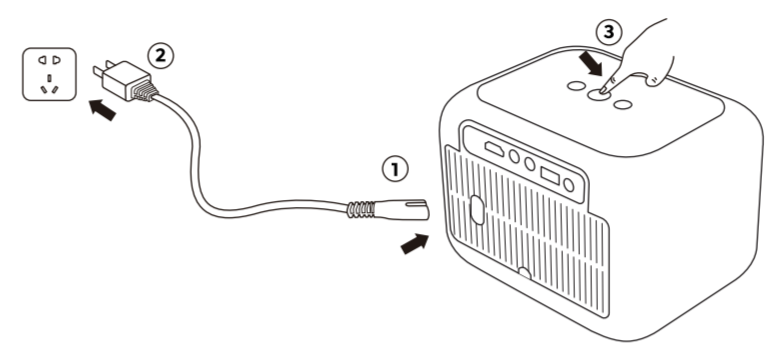

Connect Devices

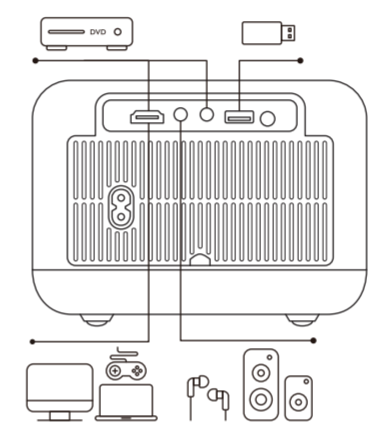

Yaber L1 projector has 4 ports, HDMI port/Headphone Port/AV port/USB port. Please select the correct connecting port to connect your device (PC, Phone, DVD Player, Sound bar, USB, PS4 etc.)

1.iOS Cast (for iOS Devices)

1.Go to "SETTINGS" page - Select the [Settings] menu - Select the [Wi-Fi Setting] menu - Open the Wi-Fi function - Select your home Wi-Fi from the list - Connect the L1 projector to your home Wi-Fi.

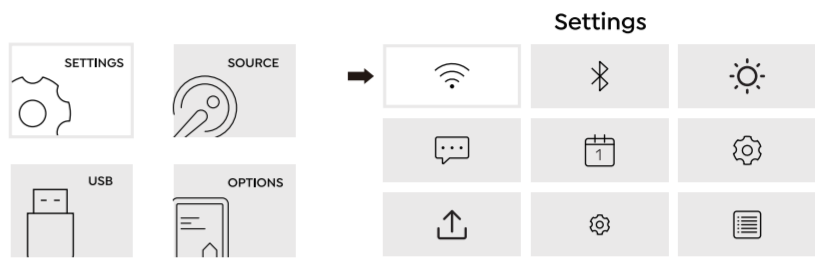

2.Go to "APPS" page - Select "My Apps" row - Find [iOS Cast] App - Press the OK button to enter the [iOS Cast] menu.

3.Select the [Settings] menu on your iOS device - Turn on the [Wi-Fi] function - Connect your iOS device to the same home network as the projector.

4.Open the [Control Center] on your iOS device - Select the [Screen Mirroring] function - Select and connect the iOS Cast receiver named [L1-Cast-XXXX] - your iOS device screen will be displayed on the projection screen after 3 seconds.

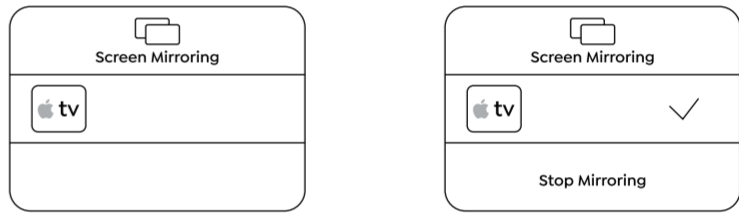

Scan and download the PDF user manual

Where to Get More Help

✉ Support@yabertech.com ✉ aftersales@yaber.com 🌐 www.yaber.com
📺 @Yaber Entertainment Projector 📺 @Yaber Entertainment Projector

2.Connect the Devices via the HDMI port

1. Connect your TV stick or laptop to any HDMI port of the projector.
- 2.Enter the home page to select the corresponding HDMI as the signal source.

3.Miracast (for Android Devices)

1.Go to "APPS" page - Select "My Apps" row - Find [Mira Cast] App - Press the OK button to enter the [Cast] menu.



2.Select the [Settings] menu on your Android device - Select the [Screen mirroring] function - Select your Miracast receiver named [L1-Cast-XXXX] - your Android device screen will be displayed on the projection screen after 3 seconds.

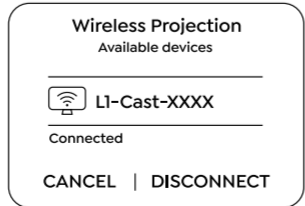
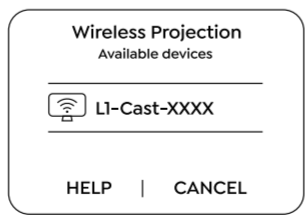

Adjust the Angle and Definition

1.Image Adjustment

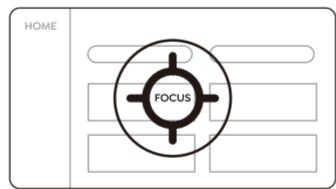

If the image is not clear. You can use the manual focus function, and press the focus buttons "F+" and "F-" on the remote control to adjust the focus of the lens, until the image is clear.

Note: If it is still blurry, please try moving projector to the best distance. The best projection distance is 2-3 meters.

Bluetooth Settings

1. Open your Bluetooth device.

2. Go to home page - Select the [🔗] menu - Select the [Bluetooth Setting]menu - Open the Bluetooth function - Select your Bluetooth device - Press the OK button to connect.

Note:

The L1 projector is compatible with the Bluetooth headsets, Bluetooth speakers and AirPods, but not the Bluetooth keyboards or Bluetooth phones.

Yaber

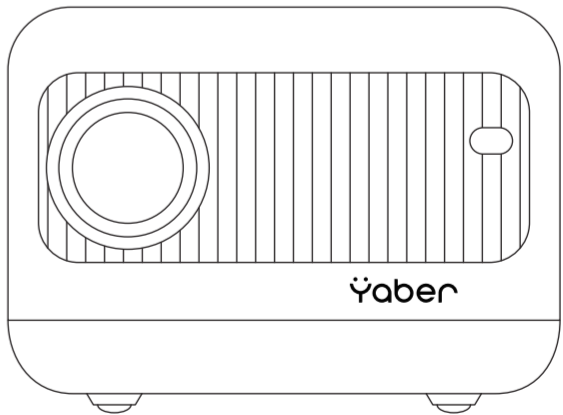

Quick Start Guide

Mini Projector L1 EN